

# Network Printing Scale

# CN1

*www.scaledirect.co.uk*



*www.scaledirect.co.uk*

## Network Printing Scale

Introducing the first product of the new CN series, CN1. CN stands for "CAS NETWORK" and is a printer scale lineup with enhanced network functionality. It features robust remote functionality based on enhanced networks and improved information transfer capability with 7" color display. Also, CN1 is compatible with the existing CL series.



# CN1 SERIES

## Overview



### Display

7" color display  
800 X 480 pixels  
16.7M colors(24bit)

### Body

Dark gray ABS upper case  
Diecasting aluminum platter

*www.scaledirect.co.uk*

*www.scaledirect.co.uk*

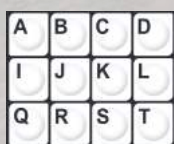

### Keyboard

Embossed key for clear touch feedback (Polydome type)  
72 PLU keys & 36 function keys

### Printer

Printing speed : 100mm/sec  
Label size : Max. width-60mm & length-290mm

## Interface

- 1) USB Port for barcode scanner, keyboard, USB memory stick
- 2) LAN for weighing network system
- 3) RJ11 for cash drawer
- 4) RS-232C for external printer, PC
- 5) Wireless LAN for Wi-Fi (optional)



Power

USB Host

LAN

RJ11

RS-232C

Wireless LAN

## ■ Feature

### Remote control & print

Via CN1 remote software, users can connect CN1 scale remotely and check status and malfunction of scale. In addition, CN1 software includes remote printing function which user can view actual CN1 printed images remotely.

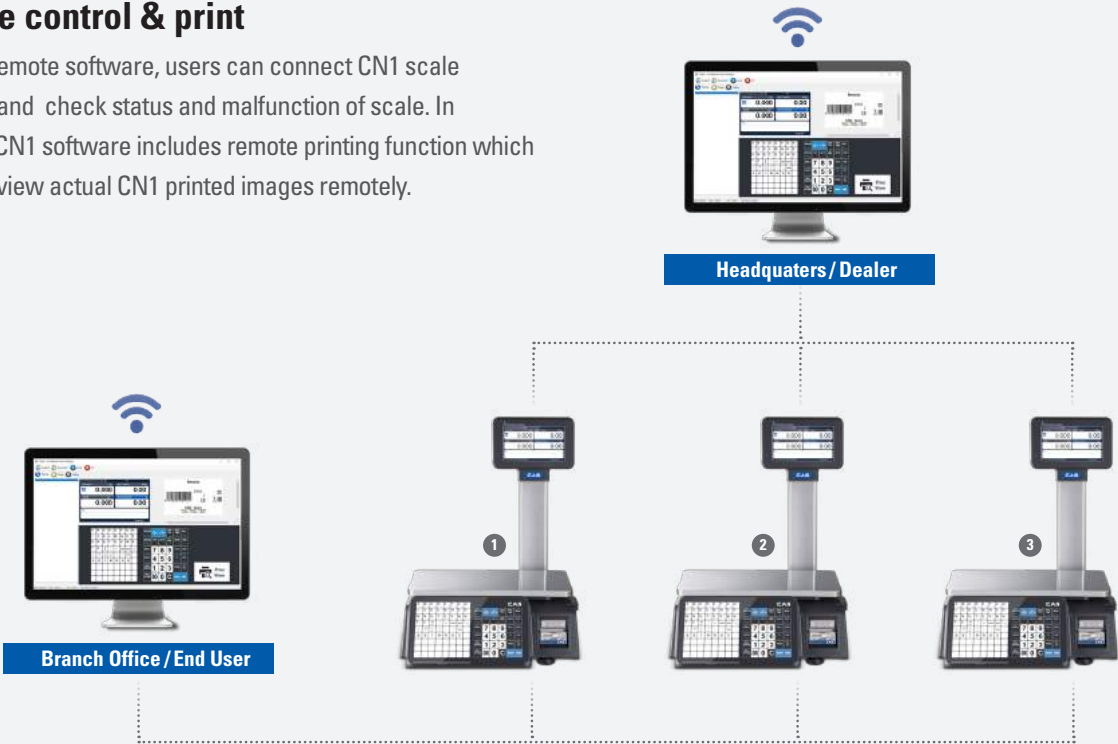

### Remote firmware update via ethernet

User can update a firmware of CN1 remotely when connected to wired or wireless ethernet. Also, Firmware updates can be easily done by connecting RS-232C or USB flash drives as before.



*www.scalesdirect.co.uk*

## 7" vivid color display

Via 7" color display with 800X480 resolution & user-friendly UI, it is easy to check product information and weight, and operate a scale.



## PLU and programmable function keys

CN1 has 72 PLU keys and 36 function keys. also, it can store up to 10,000 PLU and quickly transfer PLU data for scale to computer or computer to scale via Wi-Fi or RS-232C.



*www.scaledirect.co.uk*

## ■ Specification

MODEL	CN1			
Max. Capacity	6/15 kg	15/30 kg	15/30 lb	30/60 lb
Interval	2/5 g	5/10 g	0.005/0.01 lb	0.01/0.02 lb
Max. Tare	-9.998 kg	-9.995 kg	-9.995 lb	-29.99 lb
A/D Conversion Rate	Approx. 8 times/sec.			
Measurement Type	Load Cell			
Platter Size	380 x 250 mm			
Key	72 PLU keys, 36 function keys, 144 PLU			
Display	7" color display(800 x 480)			
Printing Speed	100 mm/sec			
Printing Resolution	202 dpi			
Label Size	Width : 40 mm ~ 60 mm / Length : 30 mm ~ 290 mm			
Barcode Type	UPC, EAN13, I2OF5, CODE128, GS1 databar, QR code			
Printer Type	Direct thermal print			
Operating Temp.	-10°C ~ 40°C (14°F ~ 104°F)			
Power	AC 100 ~ 240V 50/60Hz 1.5A			

## ■ Dimension

